

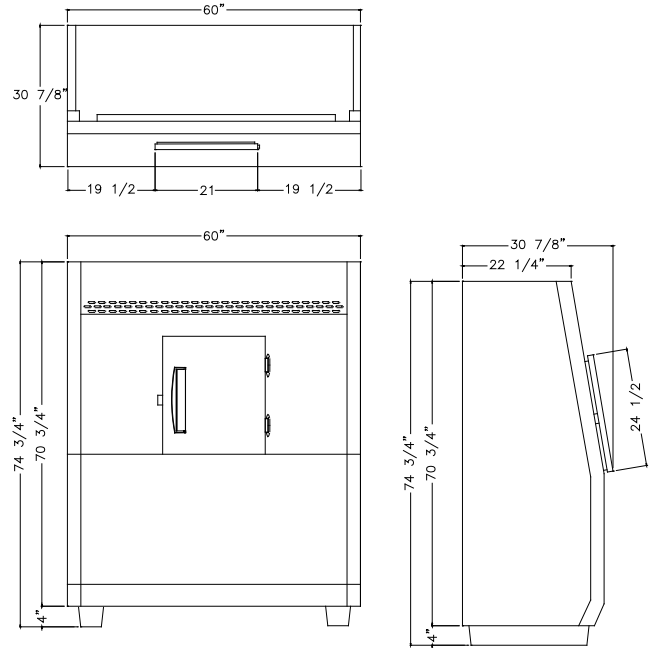

PRODUCT



TECHNICAL VIEWS



STANDARD FEATURES

- White prepainted steel exterior with stainless steel finish
- Environmentally Friendly R290 Refrigerant
- Foamed-in-placed high density polyurethane insulation: provides a solid structure and low energy consumption.

OPTIONAL FEATURES

- Voltage 220v/60Hz-50Hz
- Smart Control IoT
- Voltage regulator.

TECHNICAL SPECS

<i>Internal Capacity</i>	<i>Ft³</i> 39	<i>Liters</i> 1104.36		
<i>Exterior Dimensions</i>	<i>Width</i> 60.00" 1524.00 mm	<i>Depth</i> 30.87" 784.10 mm	<i>Height</i> 74.75" 1898.65 mm	
<i>Container Capacity</i>	<i>40 ft</i> 22	<i>45 ft</i> 25		
<i>Temperature Range</i>	<i>°C</i> -6°C -2°C	<i>°F</i> 20°F 28°F		
<i>Door(s)</i>	<i>1</i>			
<i>Weight Approx.</i>	<i>N / D</i>			
<i>Compressor HP</i>	<i>1 / 3</i>			
<i>Amperage</i>	<i>N / D</i>			
<i>Voltage/ Frequency</i>	<i>115v / 60hz</i>	<i>Plug</i>		<i>NEMA 5-15P</i>
<i>Drain Type</i>	<i>The customer has the option to connect to a drain</i>			