

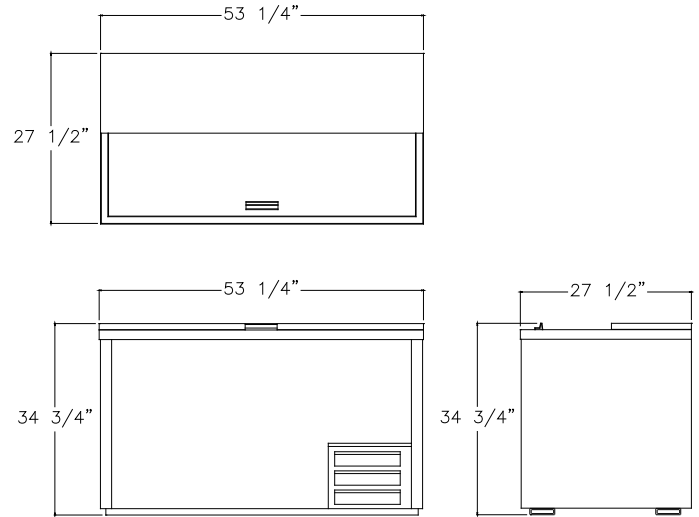

~ PRODUCT



~ TECHNICAL VIEWS



~ STANDARD FEATURES

- All stainless steel countertop and sliding lids
- Galvanized steel interior
- Bottle opener and cap-catcher
- Environmentally Friendly R290 Refrigerant
- Foamed-in-place high density polyurethane insulation: provides a solid structure and low energy consumption.

~ OPTIONAL FEATURES

- Voltage 220v/60Hz-50Hz
- Stainless steel finish
- Brand decoration
- Voltage regulator.

~ TECHNICAL SPECS

<i>Internal Capacity</i>	<i>Ft³</i> 14	<i>Liters</i> 396.44		
<i>Exterior Dimensions</i>	<i>Width</i> 53.25" 1352.55 mm	<i>Depth</i> 27.50" 698.50 mm	<i>Height</i> 34.75" 882.65 mm	
<i>Container Capacity</i>	<i>40 ft</i> 50	<i>45 ft</i> 56		
<i>Temperature Range</i>	<i>°C</i> -9°C -3°C	<i>°F</i> 15°F 25°F		
<i>Shelves</i>	<i>2</i>			
<i>Weight Approx.</i>	<i>125 kg.</i>			
<i>Compressor HP</i>	<i>1 / 4</i>			
<i>Amperage</i>	<i>n/a</i>			
<i>Voltage/Frequency</i>	<i>115v / 60hz</i>	<i>Plug</i>		<i>NEMA 5-15P</i>